



Tailgate

Replacement/Adjustment

1. Remove the screws and detach the clips, then remove the tailgate upper and lower trim panels.
2. Pull the wire harness out of the tailgate and disconnect the washer hose.
NOTE: Before pulling out the wire harness, tie a string to the end of it so you can pull it back in when the tailgate is reinstalled.
3. Remove the tailgate support struts.
NOTE: Let an assistant hold the tailgate when removing the struts.
4. Remove the tailgate by removing the tailgate mounting bolts.
NOTE: Take care not to damage the roof panel.

If necessary: Lower the rear of the headliner just enough to gain access to the hinge mounting nuts, then remove the hinge by removing the hinge mounting nuts.

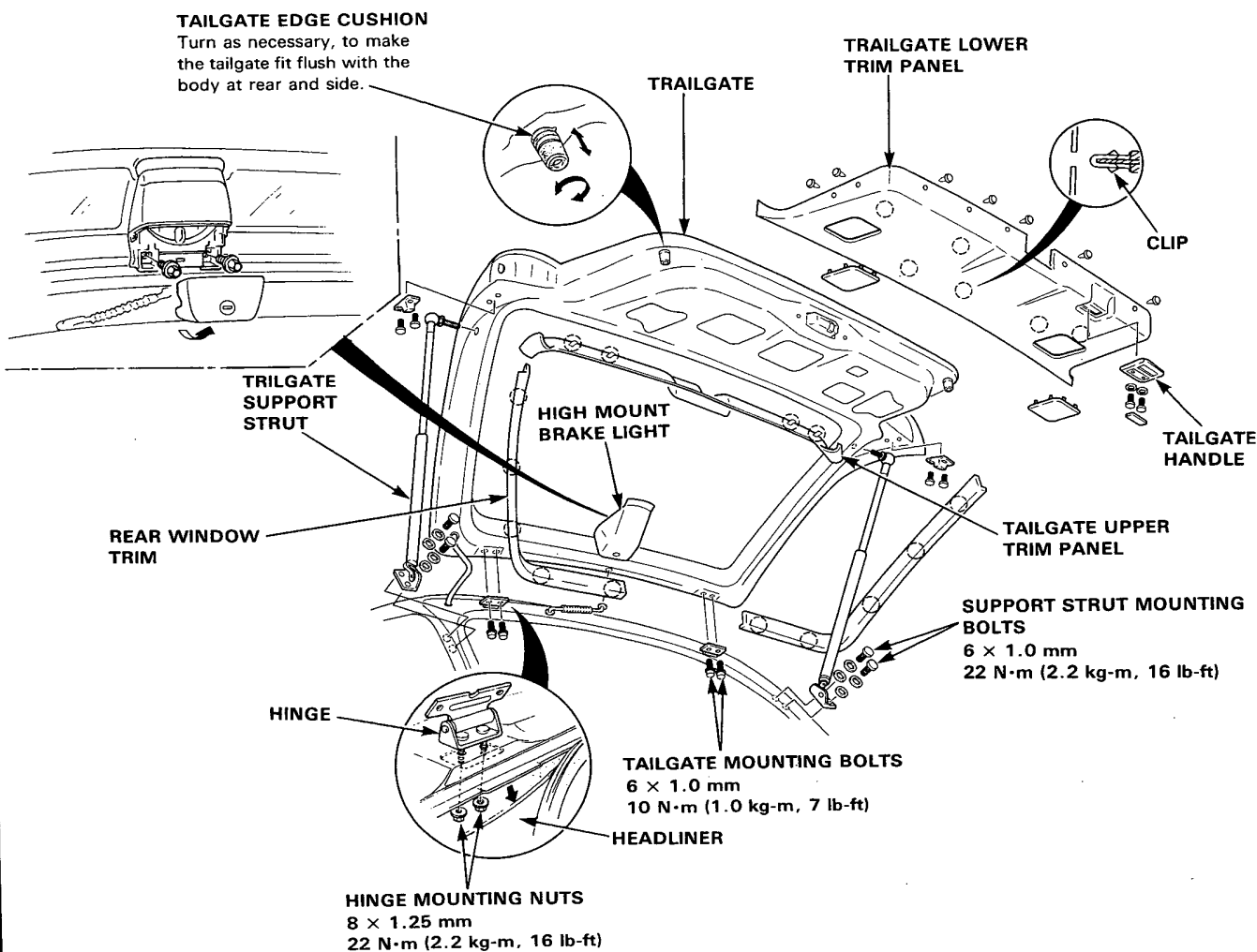

5. installation sequence is essentially the reverse order of removal. However, observe the following:
 - Before tightening the hinge nuts, adjust the tailgate fit and striker.
 - Use care when pulling the wire harness back in to avoid damaging the body.
 - Coat the inside and outside of the grommet with sealant.